

W Square in wall customized speaker

2-way 2-component speaker design

The sound is clear and accurate, with locking device. The installation is fast and simple. The surface mesh adopts ultra narrow edge design, which is simple and fashionable.

Environmental protection ABS engineering plastic box frame, fine and solid technology, high-power woofer speaker, 1 inch silk soft dome tweeter, delicate and balanced sound.

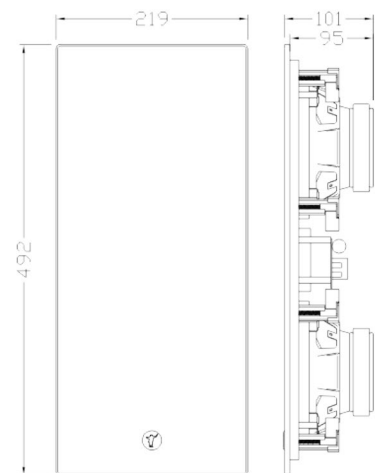
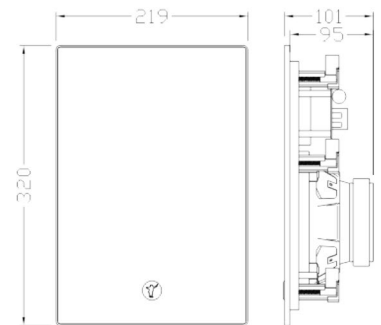

Hole size:

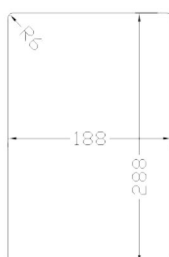

W-6

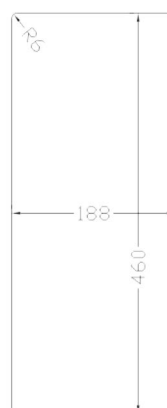

W-26

IW-6 Specification

• Driver components	1"Dome tweeter×1 , 6.5"Midrange woofer×1
• Frequency	80-20000Hz±3dB
• Impedance	8Ω
• Power Handling	110W
• Sensitivity	89dB
• Dimensions	320(H)*219(W)*101(D)mm
• Shipping dimensions	385(H)*280(W)*280(D)mm (2pcs/CTN)
• Net weight	2.2Kg /each
• Shipping weight	6Kg /each (2pcs/CTN)

IW-26 Specification

• Driver components	1" Dome tweeter×1, 6.5" Midrange woofer×2
• Frequency	80-20000Hz±3dB
• Impedance	4Ω
• Power Handling	150W
• Sensitivity	90dB
• Dimensions	492(H)*219(W)*101(D)mm
• Shipping dimensions	555(H)*275(W)*270(D)mm (2pcs/CTN)
• Net weight	3.8Kg /each
• Shipping weight	9.5Kg /each (2pcs/CTN)

W Square in wall customized speaker

2-way 2-component speaker design

The sound is clear and accurate, with locking device. The installation is fast and simple.

The surface mesh adopts ultra narrow edge design, which is simple and fashionable.

Environmental protection ABS engineering plastic box frame, fine and solid technology, high-power woofer speaker, 1 inch silk soft dome tweeter, delicate and balanced sound.

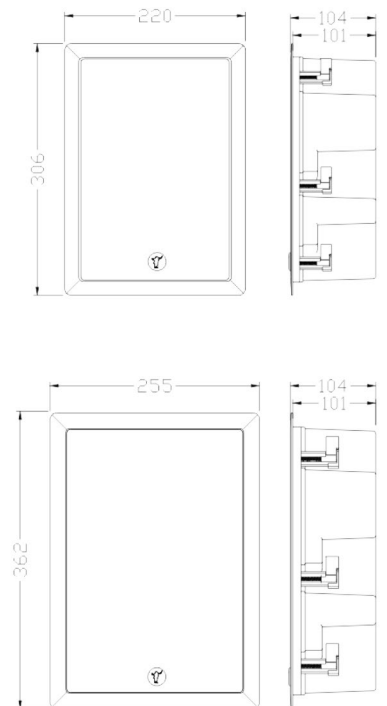

Hole size:

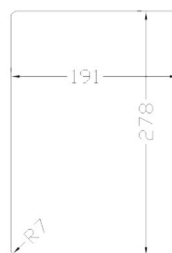

IW-106

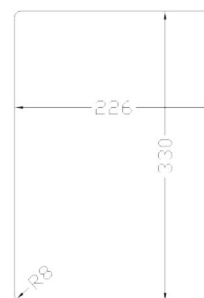

IW-108

IW-106 Specification

• Driver components	1" Dome tweeter×1 , 6.5" Midrange woofer×1
• Frequency	80-20000Hz±3dB
• Impedance	8Ω
• Power Handling	100W
• Sensitivity	89dB
• Dimensions	306(H)*220(W)*104(D)mm
• Shipping dimensions	390(H)*270(W)*270(D)mm (2pcs/CTN)
• Net weight	2.7Kg /each
• Shipping weight	6.5Kg /each (2pcs/CTN)

IW-108 Specification

• Driver components	1" Dome tweeter×1 ,8" Midrange woofer×1
• Frequency	70-20000Hz±3dB
• Impedance	8Ω
• Power Handling	150W
• Sensitivity	91dB
• Dimensions	362(H)*255(W)*104(D)mm
• Shipping dimensions	415(H)*280(W)*270(D)mm (2pcs/CTN)
• Net weight	3.3Kg /each
• Shipping weight	8.5Kg /each (2pcs/CTN)

W Series circular ceiling speaker

2-way multi speaker system design.

The sound is clear and accurate, with locking device. The installation is fast and simple. The surface mesh adopts ultra narrow edge design, which is simple and fashionable.

Environmental protection ABS engineering plastic box frame, fine and solid technology, high-power woofer speaker, 1 inch silk soft dome tweeter, delicate and balanced sound.

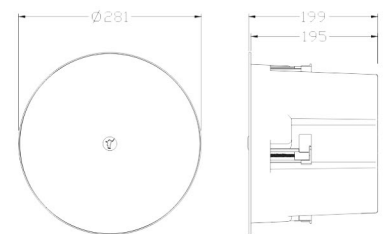
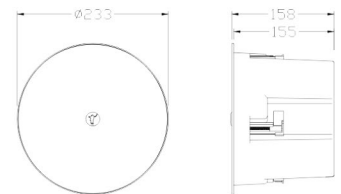

Hole size:

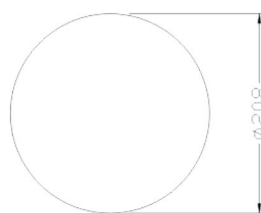

W-6.1R

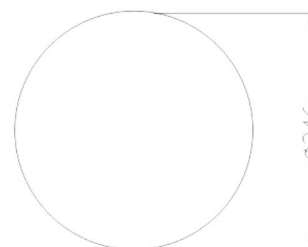

W-8.2R

IW-6.1R Specification

• Driver components	1" Dome tweeterx1, 6.5" Midrange woofex1
• Frequency	70-20000Hz±3dB
• Impedance	8Ω
• Power Handling	110W
• Sensitivity	89dB
• Dimensions	158(H)*233(D)mm
• Shipping dimensions	510(H)*275(W)*220(D)mm (2pcs/CTN)
• Net weight	2.6Kg /each
• Shipping weight	6.5Kg /each (2pcs/CTN)

IW-8.2R Specification

• Driver components	1" Dome tweeterx2 , 8" Mid-range woofex1
• Frequency	70-20000Hz±3dB
• Impedance	8Ω
• Power Handling	150W
• Sensitivity	91dB
• Dimensions	199(H)*281(D)mm
• Shipping dimensions	610(H)*320(W)*245(D)mm (2pcs/CTN)
• Net weight	3.7Kg /each
• Shipping weight	8.2Kg /each (2pcs/CTN)



IW Series circular ceiling speaker

Fullrange speaker system design.

The sound is clear and accurate, with locking device. The installation is fast and simple. The surface mesh adopts ultra narrow edge design, which is simple and fashionable.

Environmental protection ABS engineering plastic box frame, fine and solid technology.

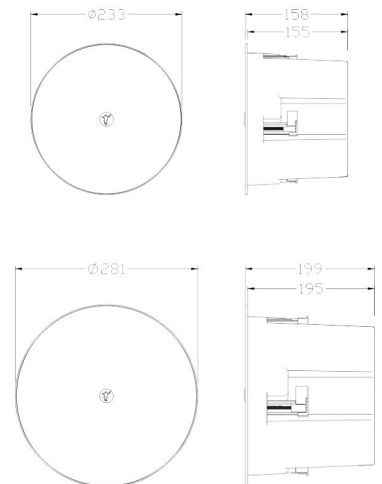

Hole size:

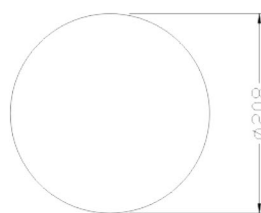

IW-6R

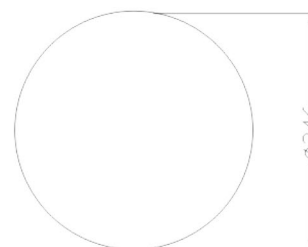

IW-8R

IW-6R Specification

• Driver components	6.5" Fullrangex1
• Frequency	70-18000Hz±3dB
• Impedance	8Ω
• Power Handling	80W
• Sensitivity	87dB
• Dimensions	158(H)*233(D)mm
• Shipping dimensions	510(H)*275(W)*220(D)mm (2pcs/CTN)
• Net weight	2.5Kg /each
• Shipping weight	6.5Kg /each (2pcs/CTN)

IW-8R Specification

• Driver components	8" Fullrangex1
• Frequency	70-18000Hz±3dB
• Impedance	8Ω
• Power Handling	100W
• Sensitivity	89dB
• Dimensions	199(H)*281(D)mm
• Shipping dimensions	610(H)*320(W)*245(D)mm (2pcs/CTN)
• Net weight	3.5Kg /each
• Shipping weight	6.5Kg /each (2pcs/CTN)

CE-6R Specification

• Driver components	6.5" Fullrangex1
• Frequency	70-20000Hz±3dB
• Impedance	8Ω
• Power Handling	60W
• Sensitivity	89dB
• Dimensions	94(H)*233(D)mm
• Shipping dimensions	510(H)*280(W)*210(D)mm (2pcs/CTN)
• Net weight	1.2Kg /each
• Shipping weight	4Kg /each (2pcs/CTN)

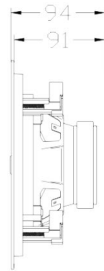
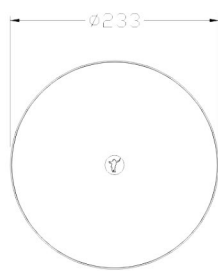

Hole size:

